

Township N° 2 North, Range N° 16 West, San Bernardino Meridian, California.

RECEIVED WITH
SRR. GEN'L'S. LETTER.
JUN 20 1896

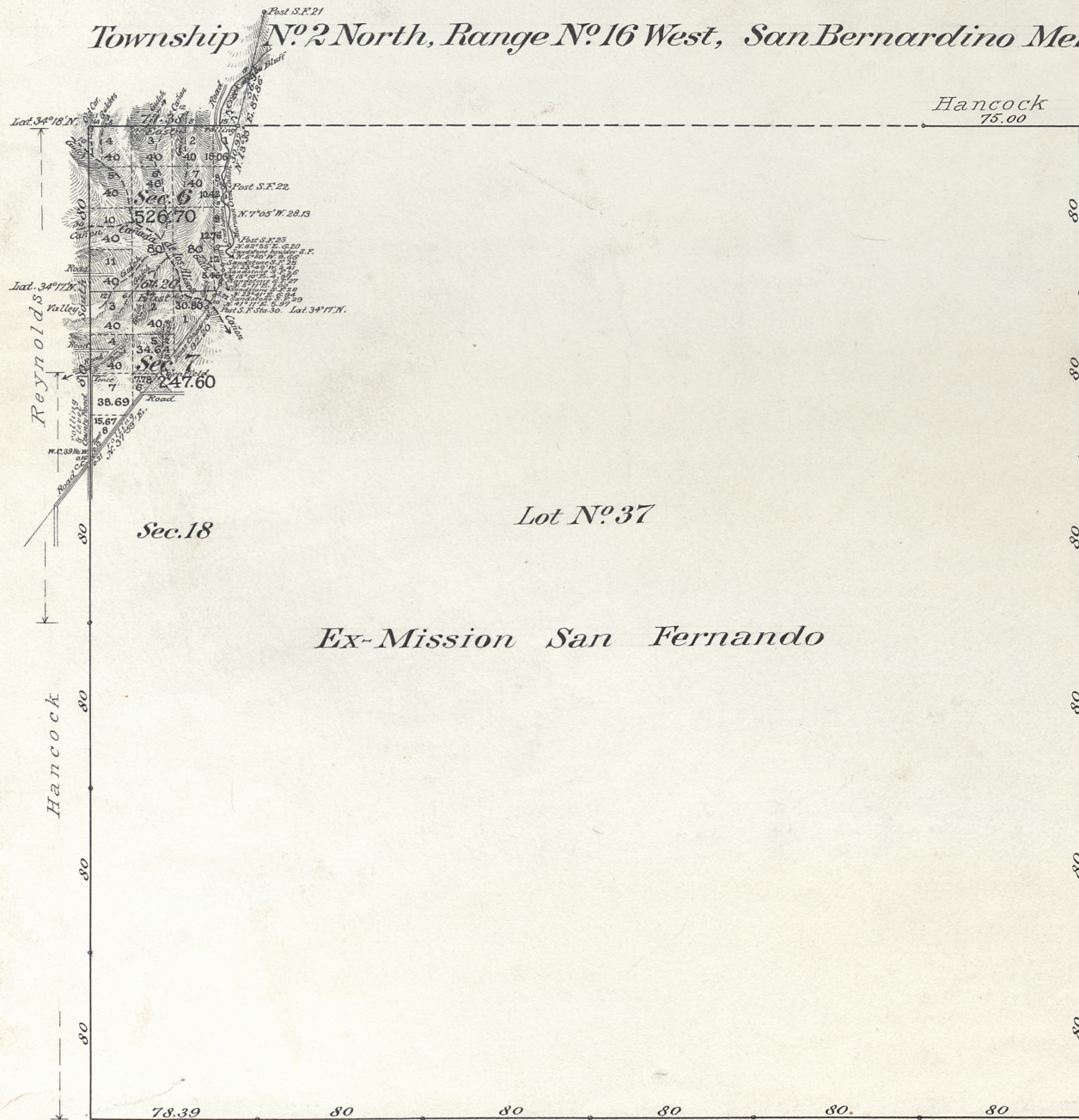

Area of Public Land 774.30 Acres
 „ „ Private Grant 22227.00 „
 Aggregate 23001.30 „

Surveys Designated	By whom surveyed	Contract		Amount of Surveys			When surveyed
		N°	Date	M.L.S.	CHS.	LKS.	
East boundary of Township	R. W. Norris	—	Oct. 12, 1853	—	—	—	1854
S. and parts of N. & W. 1/4 of T. 2	H. Hancock	—	Dec. 30, 1853	—	—	—	1854
Part of W. boundary of T. 2	W. P. Reynolds	—	March 19, 1872	—	—	—	1872
Boundaries of Lot N° 37	H. Hancock	—	Sept. 1, 1858	—	—	—	1858
Parts of N. & W. 1/4 of T. outside of Lot 37	J. R. Glover	382	Nov. 20, 1884	—	—	—	1895
Boundaries of Lot N° 37, resurveyed	„	„	„	—	—	—	„
Section lines, new	M. F. Reilly	383	Nov. 20, 1884	—	61	33	1895
Connecting lines, „	„	„	„	—	3	43	Nov. 30, 1895

The above Map of Township N° 2 North, Range N° 16 West, San Bernardino Meridian, California, is strictly conformable to the field notes of the surveys thereof, on file in this Office, which have been examined and approved.

U. S. Surveyor-General's Office,
 San Francisco, California,
 June 20th 1896.

See office-letter of even date.

W. S. Jordan
 U. S. Surv. Gen'l, Cal.

Posted Sept 1896